

DPL66-SDXXX9X-40W-XXX Data Sheet

Features(產品特性)

- ◆New modcm stlyc
(結構緊湊，造型極富現代時尚)
- ◆Stable and Hi-quality LED chips
(高品質LED光源，性能穩定)
- ◆Long Lifetime >40000 hours
(壽命>40000小時)
- ◆No mercury and ROHS compliant
(沒有汞可通過無鉛環保認證)
- ◆Full range of white colors available
(白光全系列色溫都可選擇)
- ◆ Power consumption upto **40W** for
Length X Width **600 X 600 mm**
(消耗功率:40W, 尺寸:600*600MM)



Typical Applications(典型應用)

- ◆ Indoor Lighting (室內照明)
- ◆Office Lighting(辦公照明)
- ◆Direct replace the traditional Grille lamps(可直接替代傳統格柵燈)

Product Specifications(產品規格)

Parameter(參數)	Description(描述)
Shellmaterial (主體材質)	Anodizing Aluminum (鋁合金) +stainless steel (不銹鋼)
Face Mask (面罩)	PC Diffusion (PC 擴散板)
Surface color(外觀顏色)	White (白色)
Operation Temperature(操作溫度)	-20°C ~+40°C
Storage Temperature(儲存溫度)	-40°C ~+70°C
Ac to DC Power Supply(驅動電源參數)	AC input and 40 VDC (max) /Constant current 1000mA output (最大電壓 DC40V/恒電流 1000MA)

DPL66-SDXXX9X-40W-XXX Data Sheet

Part Number Explanation(產品編碼)

Style(款式)	Model(產品類型)	Specialcode(尺寸規格)
DPL66-SDXXX9X-40W-XXX	D PL 66-SDXXX9X-40W-XXX	DPL 66 -SDXXX9X-40W-XXX
D: Straight down (直下式)	PL: Panel Lights (面板燈)	66: 600*600mm

LED Type(LED 類型)	CRI(顯色指數)	CCT(色溫)
DPL66- S DXXX9X-40W-XXX	DPL66-SD D XXX9X-40W-XXX	DPL66-SD XX 9X-40W-XXX
S: SMD LED	D: ≥ 80 Ra	30: 2500~3500K
		40: 3500~4500K
		60: 5500~6500K

Cover(導光面類型)	Input Voltage(使用電壓)	Power Factor(功率因數)
DPL66-SDXX X 9X-40W-XXX	DPL66-SDXXX X 9X-40W-XXX	DPL66-SDXXX 9 X-40W-XXX
B: Haze (擴散面)	A: AC 175~265V	9: ≥ 0.9
	C: AC 90~305V	

Power Specification (電源類型)	Wattage(消耗功率)	Certification (安規類型)
DPL66-SDXXX9 X -40W-XXX	DPL66-SDXXX9X- 40W -XXX	DPL66-SDXXX9X-40W- XXX
F: No certification(無安規認證)	40W : 40W	-: BSMI certification (台灣認證)
C: Safety certification (有安規認證)		CE: CE certification (CE 認證)

Specifications of Haze Cover Series(光電參數)

Model No. (產品型號)		DPL66-SDXXBX9X-40W-XXX	
Parameter (參數)		Min.	Typ.
Power Consumption (W) (消耗功率)			40
Net Weight (kg) (產品重量)			1.45
D30(2500~3500K)	Luminous Flux(lm) (光通量)		3900
D40(3500~4500K)	Illuminance @ 1m(lux) (1米照度)	790	
D60(5500~6500K)	Luminous Flux(lm) (光通量)		4200
	Illuminance @ 1m(lux) (1米照度)	850	

Power Consumption, Weight, Luminous flux measurement allowance is $\pm 15\%$.

All specifications involving life and performance are based upon a 25°C ambient temperature.

(以上資料公差為 $\pm 15\%$ 、測試的資料是在25°C的環境溫度下進行)

DPL66-SDXXX9X-40W-XXX Data Sheet

Mechanical Dimensions (產品尺寸圖)

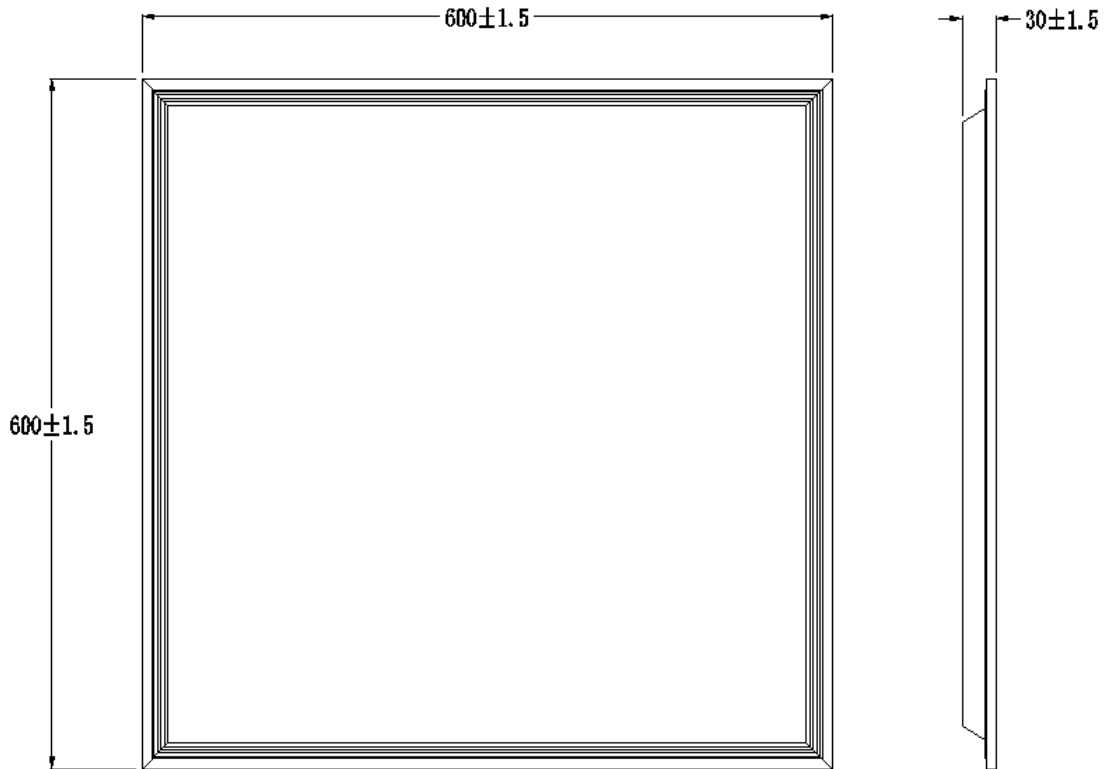

- Notes(注釋): 1. Dimensions are in millimeters (上圖尺寸資料單位為: MM)
2. Tolerances unless dimensions ± 3 mm (沒注公差的數據公差為: ± 3 mm)

DPL66-SDXXX9X-40W-XXX Data Sheet

Installation(安裝)

一、 Embedded installation of led panel light(嵌入式安裝)

1、remove the ceiling

(取下天花石膏板)

2、make sure the power wires connected

(連接好電源線)

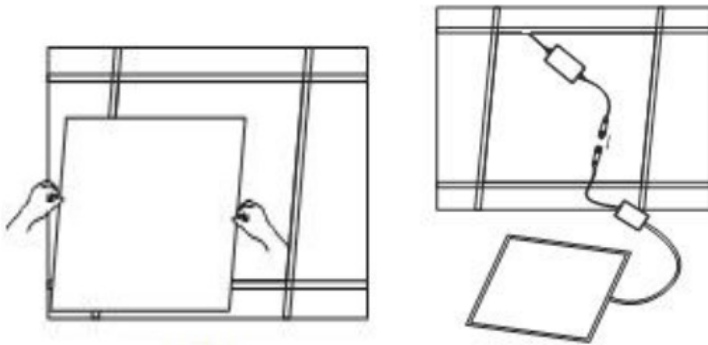

3、make the panel light placed above the ceiling

(將平板燈放在吊頂卡位上)

4、make the panel light and the ceiling lanterns position adjustment aligned, then you can open and lighting

(將平板燈放平穩後，便可通電使用)

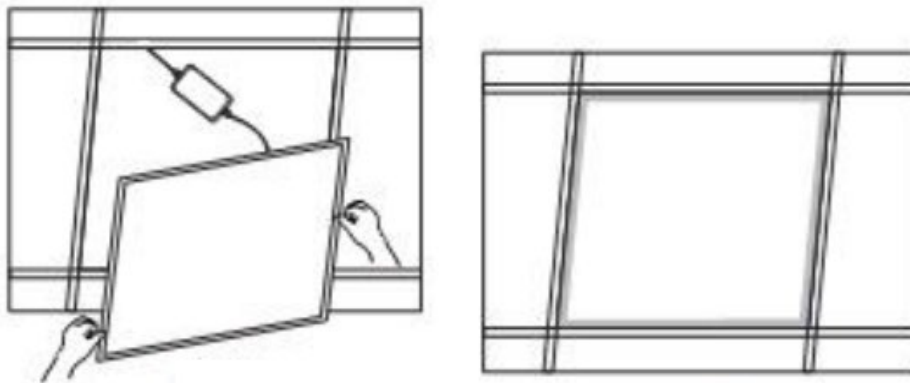

二、 Suspension installation of LED panel light(吊裝式安裝)

1、make the corner fixing parts installed above panel lamp

(取下卡座，自攻螺絲裝入卡座內)

2、make the corner fixing parts installation the ceiling top

(將卡座固定在天花板上)

DPL66-SDXXX9X-40W-XXX Data Sheet

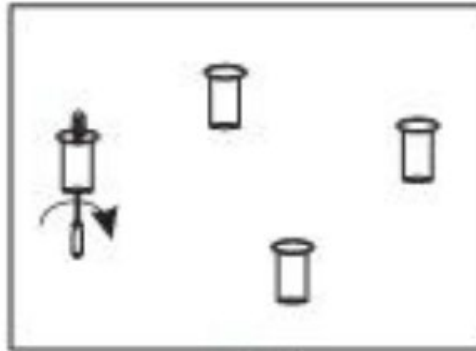
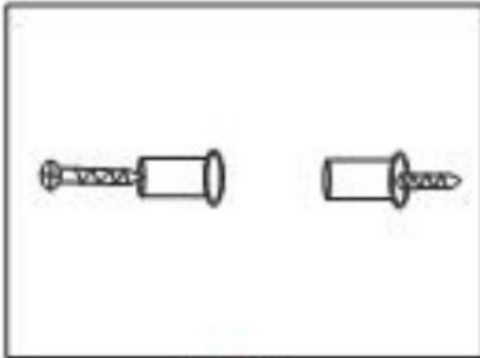

3 · make the glue plue into open good holes.
screw through fixed cap.locked in plug hole.
(線器鎖到卡座上)

4 · adjust the steel rope length,an ensure
Power input connected With AC power
supply,then you can open an lighting
(調節好鋼繩長度，連接好電源，可通電使用)

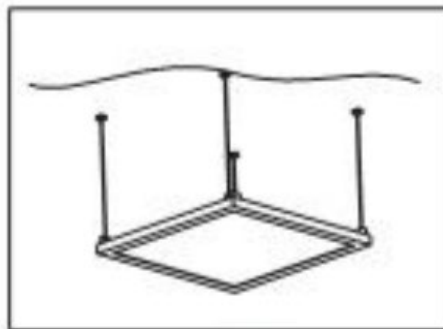
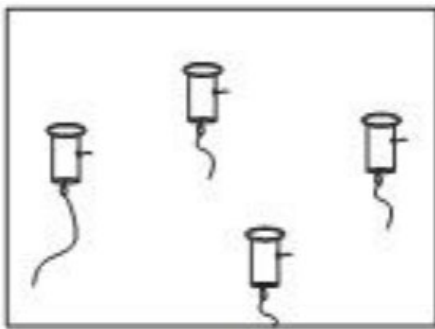

PACKAGE (包裝)

Net weght per light(淨重): 8.7kg

Gross weight(毛重):9.6kg/carton

Carton: 6 PCS Unit Boxes (6 個為一箱) Meas(外箱尺寸):660*240*655mm

